

Job Aid

BD FACSCelesta™, BD LSRFortessa™, and BD FACSymphony™ Analyzer families: Flushing the system with standard fluidics and the BD® High Throughput Sampler (HTS) option

This job aid contains instructions for performing a system flush on BD LSRFortessa™, BD FACSCelesta™, and BD FACSymphony™ Flow Cytometers with the BD® High Throughput Sampler (HTS) option. A system flush cleans the overall fluidics to remove debris and contaminants from the sheath and waste tubing, and flow cell. Perform the system flush at least every two weeks. See your instrument's user guide for additional information.

Before you begin

You will need the following items:

- Stainless steel sheath tank
- 2 L of undiluted BD FACSClean™ Solution or a freshly prepared 10% bleach solution
- 2 L of deionized (DI) water

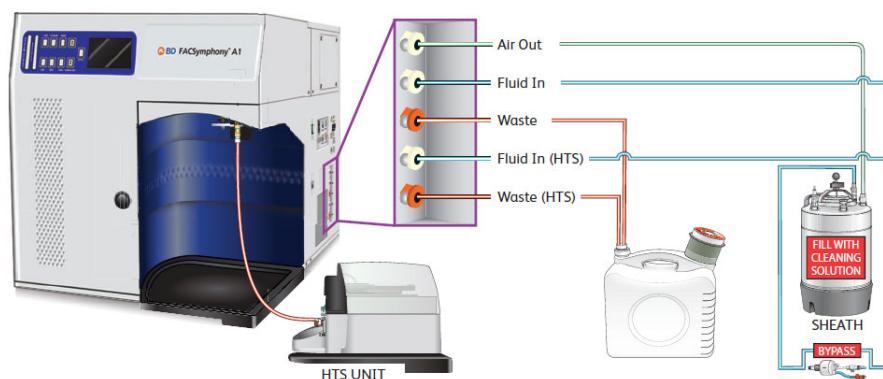

Bypass the sheath filter

NOTE Do not run detergent, bleach, or ethanol through the sheath filter. These fluids can break down the filter paper within the filter body, causing particles to escape into the sheath fluid, possibly clogging the flow cell.

Bypassed sheath filter

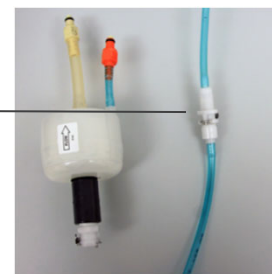

- ① Press the quick-disconnects on both sides of the filter assembly.
- ② Remove the filter assembly.
- ③ Connect the two fluid lines.
- ④ Empty the stainless steel sheath tank and rinse it with DI water. Empty the waste tank, if needed.

Flushing the system

- ① Fill the stainless steel sheath tank with 2 L of undiluted BD FACSClean™ Solution or a freshly prepared 10% bleach solution.
- ② Connect the sheath tank. Open the roller clamp on the sheath line for about 10 seconds and drain the fluid into the beaker. Close the roller clamp.
- ③ Confirm that the HTS sample coupler is connected, or install if necessary.
- ④ Place the cytometer in run mode. From the cytometer menu, select **HTS > Prime**. After completion, repeat the prime.
- ⑤ Select **HTS > Monthly Clean**, then click **Continue**.
A dialog appears while cleaning is in progress; this can take up to 30 minutes.
- ⑥ When prompted, empty the sheath tank and replace the cleaning solution with DI water.
- ⑦ Reinstall the tank, then click **Continue**.
A dialog appears while rinsing is in progress; this can take up to 30 minutes.
- ⑧ Click **OK** when monthly cleaning is complete.

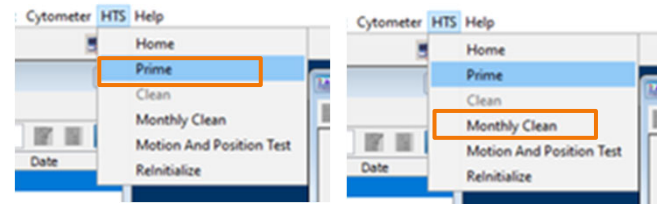
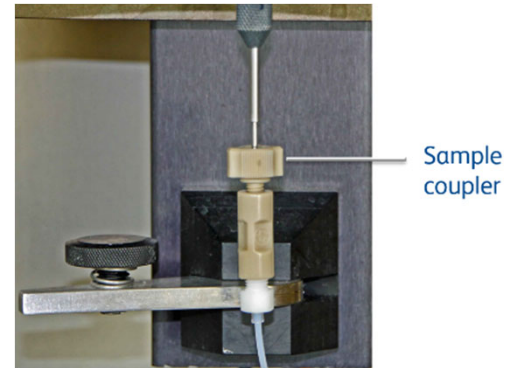

Re-establishing the connections

- ① Disconnect the air line from the sheath tank, fill the tank with sheath fluid, and reconnect it.
- ② Reconnect the sheath filter.
- ③ Check for bubbles and purge the sheath line or sheath filter, if needed.

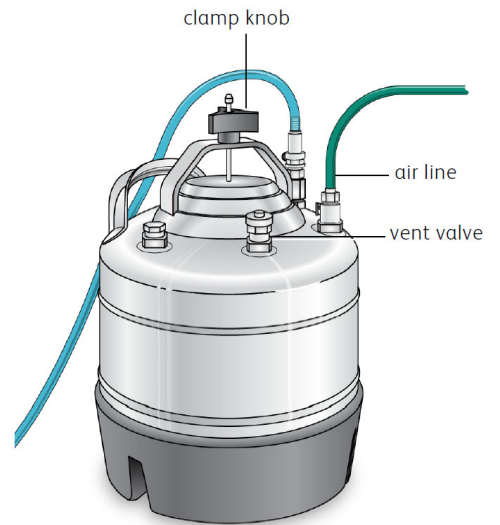

Connected sheath filter



Class I Laser product
This material is for training purposes.
For Research Use Only. Not for use in diagnostic or therapeutic procedures.
BD-72622 (v1.0)

BD Life Sciences, San Jose, CA, 95131, USA

bdbiosciences.com

BD, the BD Logo, BD FACSCelesta, BD FACSClean, BD FACSTFlow, BD FACSSymphony and BD LSRFortessa and are trademarks of Becton, Dickinson and Company or its affiliates. ©2022 BD. All rights reserved.

